



CAST 2PC BALL VALVE



GAMA ENGINEERING WORKS

OUR QUALITY BUILDS CUSTOMERS CONFIDENCE & RELATIONS.

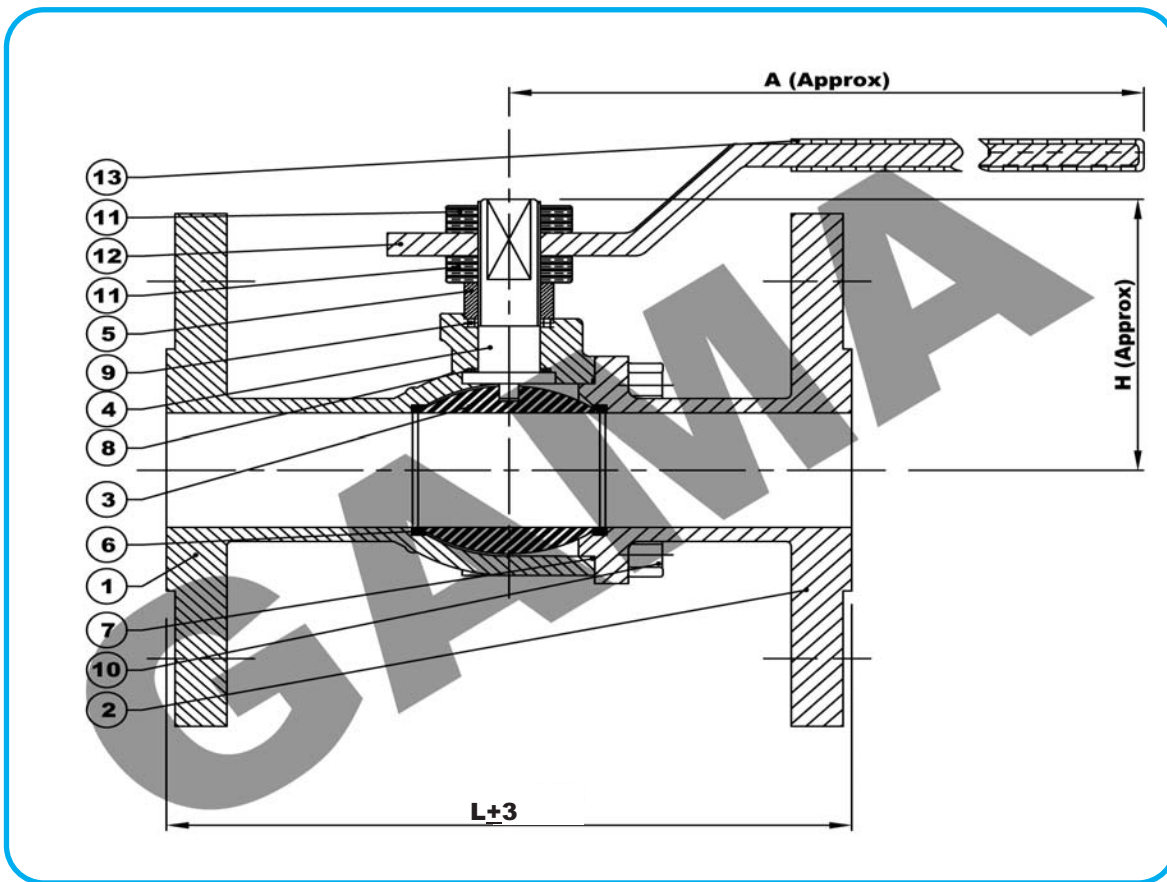

Size IN MM	PORT IN MM	L		H	A
		150#	300#		
15	12.5	108	140	34	130
20	17	117	152	45	130
25	24	127	165	56	150
40	37	165	191	76	195
50	49	178	216	85	195
65	63	190.5	241	102	255
80	75	203	283	115	300
100	98	229	305	142	345
125	127	254	354	200	355
150	148	267	403	240	650
200	198	292	419	300	750

13	1	SLEEVE	PVC
12	1	HANDLE WITH NUT	M.S. / S.S.
11	2	GLAND NUT & STEM NUT	M.S. / S.S.
10	Req.	BODY/CONNECTOR BOLTS	B7 & 2H / B8 & 8M
9	Req.	GLAND PACKINGS	PTFE / CFT / GFT
8	1	STEM PACKING	PTFE / CFT / GFT
7	2	BODY SEAL	PTFE / CFT / GFT
6	2	BALL SEAT	PTFE / CFT / GFT
5	1	GLAND	AISI 304 / 316
4	1	STEM	AISI 304 / 316
3	1	BALL	CF 8 / CT 8M (HALLOW / SOLID)
2	1	CONNECTOR	C.S. / CF 8 / CF 8M
1	1	BODY	C.S. / CF 8 / CF 8 M
P.No.	Qty.	Nomenclature	Material

TEST PRESSURE PSIG		
TESTING	BODY	SEAT
HYDRAULIC	435 / 1132	325 / 827
PNEUMATIC	-	100

TECHNICAL DATA :	
Manufacturing Std	ISO 17292 / BS 5351
Face to Face	ASME B 16.10
End Connection	Flanged Ends to ASME B 16.5 RF
Inspection & Testing Std.	BS 6755 (Part-1)



GAMA ENGINEERING WORKS



OUR QUALITY BUILDS CUSTOMERS CONFIDENCE & RELATIONS.
AN ISO 9001:2015 Certified Company.

49/98, Ashokpura, O/s. Shahpur Gate, Dudheshwar Road, Ahmedabad-380004.

Ph. (0) 079 - 25622479 | Web : www.gewvalves.com | E-mail : sales.gewvalves@gmail.com

2 Piece Flanged end ball Valve

Size 15mm to 200mm CLASS : 150& 300

NOTES : 1.) OTHER MATERIAL LIKE ASTM A 351 Gr. CF 3/CF 3M, HASTEALLOY 'C', (DUPLEX SS) ASTM A 890 Gr. 4A, 5A, 6A ARE ALSO AVAILABLE.
 2.) DEVELOPMENT IS CONTINUE, HENCE SPECIFICATION ARE SUBJECT TO CHANGE AT ANY TIME WITHOUT NOTICE.